

Mounting Plates

for Mounting Blocks of Ball Catches GN 4490,
Stainless Steel

SPECIFICATION

Type

- Type **F**: Flat

Stainless steel AISI 316 A4

Matte shot-blasted **GS**

INFORMATION

Mounting plates GN 4490.2 enlarge the contact surface of the mounting blocks of ball catches GN 4490 (see page). This allows mounting blocks to be securely attached to aluminum profiles regardless of the slot width.

ACCESSORY

- GN 50b T-Nuts (see page)
- GN 50i T-Nuts (see page)
- GN 51b T-Slot Nuts (see page)

TECHNICAL INFORMATION

- Stainless Steel Characteristics (see page A26)

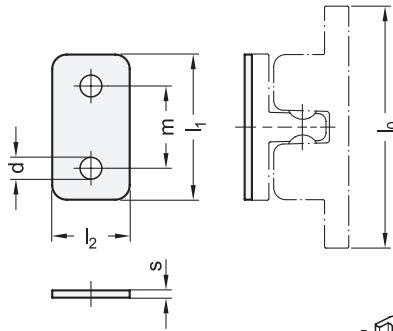

Assembly instruction

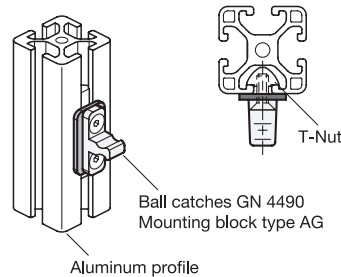

GN 4490.2

STAINLESS STEEL

Description	l_0 Length of ball catch	d	l_1	l_2	m	s	For aluminum profiles with grid size	⚖
GN 4490.2-A4-50-F-GS	50	4.5	30	16	17	2	20 / 30 / 40 / 45	7
GN 4490.2-A4-68-F-GS	68	4.5	32.5	17	20	2	20 / 30 / 40 / 45	8
GN 4490.2-A4-80-F-GS	80	5.5	40	20	25	2	20 / 30 / 40 / 45	12